

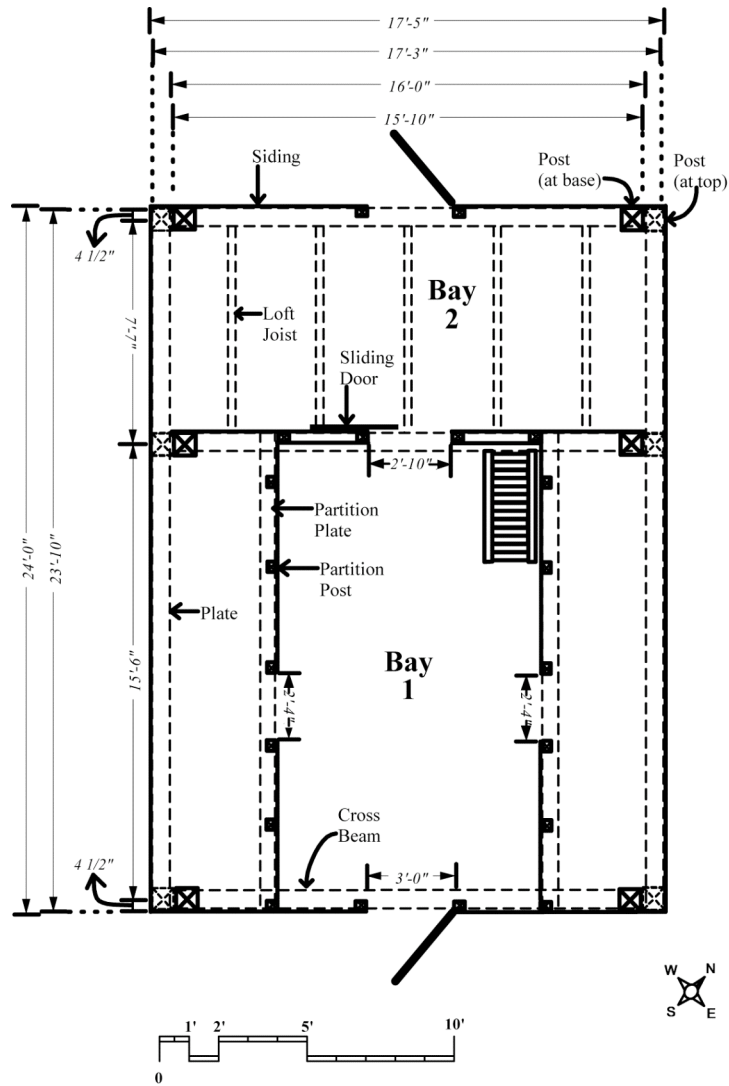

HISTORIC BARNS OF NIPMOOSE

CORN CRIB STRUCTURAL DRAWING: FLOOR PLAN



BEAM DIMENSIONS: WIDTH AND DEPTH

- Cross Beam:** 8 in. wide x 10 in. deep
- Partition Plate:** 8 in. wide x 5 in.
- Plate:** 8 in. wide x 8 in. deep
- Post:** 9 in. x 9 in.
- Siding:** One inch thick